



**COMPOSITE COMPUTER REGISTER  
UNDER LAND TRANSFER ACT 1952**



**Guaranteed Search Copy issued under Section 172A  
of the Land Transfer Act 1952**

  
R. W. Muir  
Registrar-General  
of Land

**Identifier** NA48D/1068  
**Land Registration District** North Auckland  
**Date Issued** 29 January 1981

**Prior References**

NA902/125

---

**Estate** Fee Simple - 2/3 share  
**Area** 1075 square metres more or less  
**Legal Description** Lot 6 Deposited Plan 34905

**Proprietors**

James Baxter Buchan and Maureen Buchan

---

<b>Estate</b>	Leasehold	<b>Instrument</b>	L 782525.1
		<b>Term</b>	999 years commencing on the 1.12.1980

**Legal Description** Flat 1 Deposited Plan 92363 and Garage 1  
Deposited Plan 92363

**Proprietors**

James Baxter Buchan and Maureen Buchan

**Interests**

782525.1 Lease of Flat 1 and Garage 1 DP 92363 Term 999 years commencing on the 1.12.1980 Composite CT NA48D/1068 issued - 29.1.1981 (Affects Fee Simple)

782525.2 Lease of Flat 2 and Garage 2 Composite CT NA48D/1069 issued - 29.1.1981 (Affects Fee Simple)

8557612.2 Mortgage to Bank of New Zealand - 6.8.2010 at 11:27 am

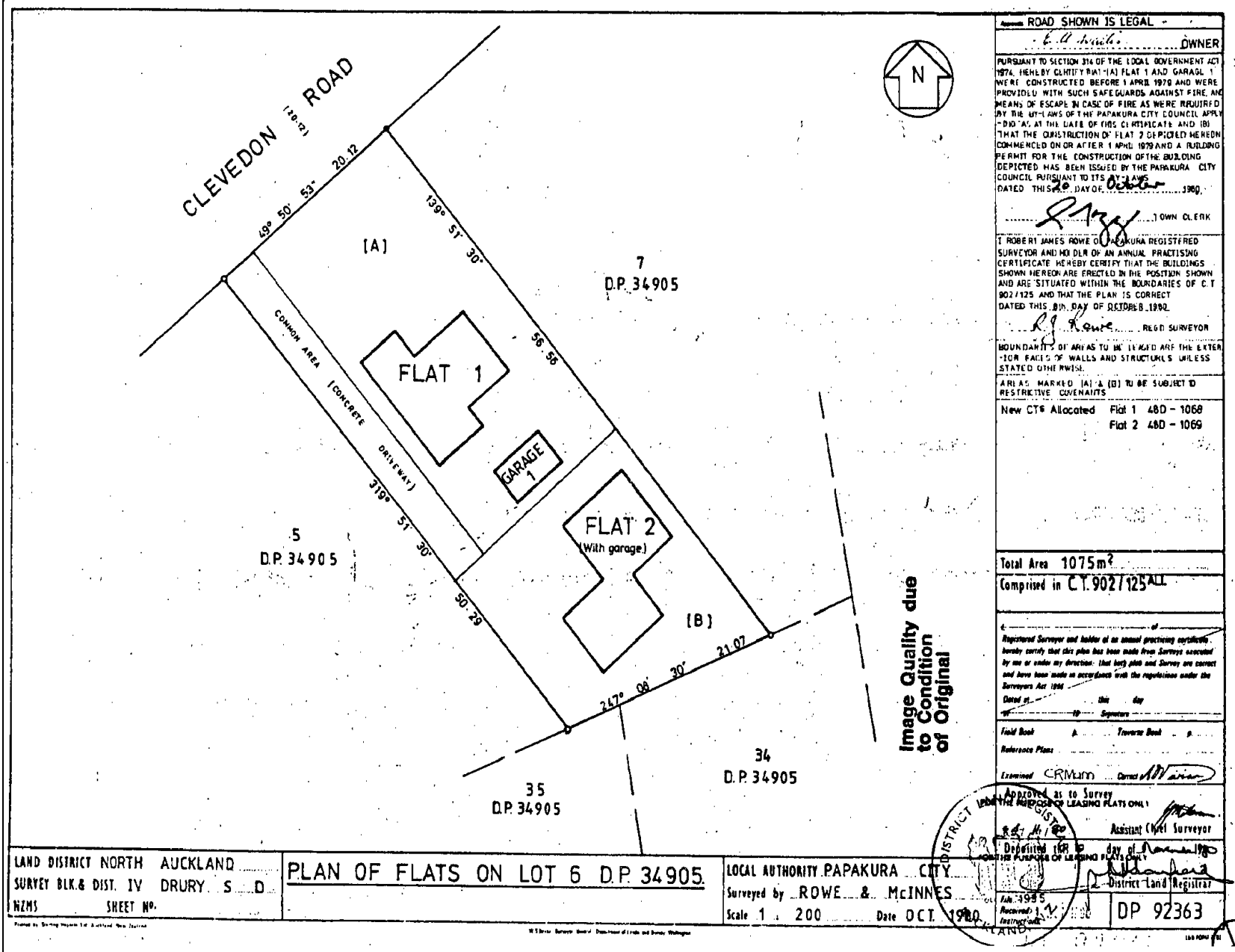

Image Quality due to Condition of Original

ROAD SHOWN IS LEGAL

*6.11.1980* OWNER

PURSUANT TO SECTION 314 OF THE LOCAL GOVERNMENT ACT 1974, HEREBY CERTIFY THAT (A) FLAT 1 AND GARAGE 1 WERE CONSTRUCTED BEFORE 1 APRIL 1970 AND WERE PROVIDED WITH SUCH SAFEGUARDS AGAINST FIRE AND MEANS OF ESCAPE IN CASE OF FIRE AS WERE REQUIRED BY THE BY-LAWS OF THE PAKAPURA CITY COUNCIL APPLICABLE AT THE DATE OF THIS CERTIFICATE AND (B) THAT THE CONSTRUCTION OF FLAT 2 DEPICTED HEREON COMMENCED ON OR AFTER 1 APRIL 1970 AND A BUILDING PERMIT FOR THE CONSTRUCTION OF THE BUILDING DEPICTED HAS BEEN ISSUED BY THE PAKAPURA CITY COUNCIL PURSUANT TO ITS BY-LAWS DATED THIS 20 DAY OF October 1980.

*[Signature]* TOWN CLERK

*R.J. Rowe* REGD SURVEYOR

I ROBERT JAMES ROWE OF PAKAPURA REGISTERED SURVEYOR AND MEMBER OF AN ANNUAL PRACTISING CERTIFICATE HEREBY CERTIFY THAT THE BUILDINGS SHOWN HEREON ARE ERECTED IN THE POSITION SHOWN AND ARE SITUATED WITHIN THE BOUNDARIES OF C.T. 902/125 AND THAT THE PLAN IS CORRECT DATED THIS 20 DAY OF October 1980.

BOUNDARIES OF AREAS TO BE LEASED ARE THE EXTERIOR FACES OF WALLS AND STRUCTURES UNLESS STATED OTHERWISE.

AREAS MARKED (A) & (B) TO BE SUBJECT TO RESTRICTIVE COVENANTS

New CTS Allocated Flat 1 48D - 1069  
Flat 2 48D - 1069

Total Area 1075m<sup>2</sup>  
Comprised in C.T. 902/125 ALL

I, R.J. Rowe Registered Surveyor and holder of an annual practicing certificate hereby certify that this plan has been made from surveys executed by me or under my direction that bearings and distances are correct and have been made in accordance with the regulations under the Surveyors Act 1966

Dated at Papakura this 20 day of October 1980

Field Book A Traverse Book B

Reference Plans

Examined C.R. McLean Correct Atkinson

Approved as to Survey [Signature] Assistant Chief Surveyor

Deposited for registration [Signature] District Land Registrar

DP 92363

Scale 1 : 200 Date OCT. 1980

Identifier NA48D/1068

LAND DISTRICT NORTH AUCKLAND  
SURVEY BLK. & DIST. IV DRURY. S D  
NZMS SHEET NO.

PLAN OF FLATS ON LOT 6 D.P. 34905

LOCAL AUTHORITY PAKAPURA CITY  
Surveyed by ROWE & McINNES  
Scale 1 : 200 Date OCT. 1980

