



**RECORD OF TITLE
UNDER LAND TRANSFER ACT 2017
UNIT TITLE**

**Guaranteed Search Copy issued under Section 60 of the Land
Transfer Act 2017**



R. W. Muir
Registrar-General
of Land

Identifier **NA68C/382**
Land Registration District **North Auckland**
Date Issued 01 October 1987

Prior References
NA387/293

Supplementary Record Sheet
NA68C/385

Estate Stratum in Freehold
Legal Description Unit G and Accessory Unit 7 and 1/2 share
in Accessory Unit 12 and 1/3 share in
Accessory Unit 13 and 1/5 share in
Accessory Unit 19 Deposited Plan 119300

Registered Owners
Alvin Stephen Roberts as Administrator

The above estates are subject to the reservations, restrictions, encumbrances, liens and interests noted below and on the relevant unit plan and supplementary record sheet

Identifier

NA68C/382



**SUPPLEMENTARY RECORD SHEET
UNDER UNIT TITLES ACT 1972**

**Guaranteed Search Copy issued under Section 60 of
the Land Transfer Act 2017**

Identifier

NA68C/385

Land Registration District

North Auckland

Date Issued

01 October 1987

Plan Number

DP 119300

Subdivision of

Lot 74 Deposited Plan 5019

Unit Titles Issued

NA68C/376

NA68C/377

NA68C/378

NA68C/379

NA68C/380

NA68C/381

NA68C/382

NA68C/383

NA68C/384

Interests

OWNERSHIP OF COMMON PROPERTY

Pursuant to Section 47 Unit Titles Act 2010 -

(a) the body corporate owns the common property and

(b) the owners of all the units are beneficially entitled to the common property as tenants in common in shares proportional to the ownership interest (or proposed ownership interest) in respect of their respective units.

The above memorial has been added to Supplementary Record Sheets issued under the Unit Titles Act 1972 to give effect to Section 47 of the Unit Titles Act 2010.

Fencing Agreement in Transfer 176521

Fencing Agreement in Transfer 76161

B735749.2 Change of rules of the Body Corporate - 1.10.1987 at 3.00 pm

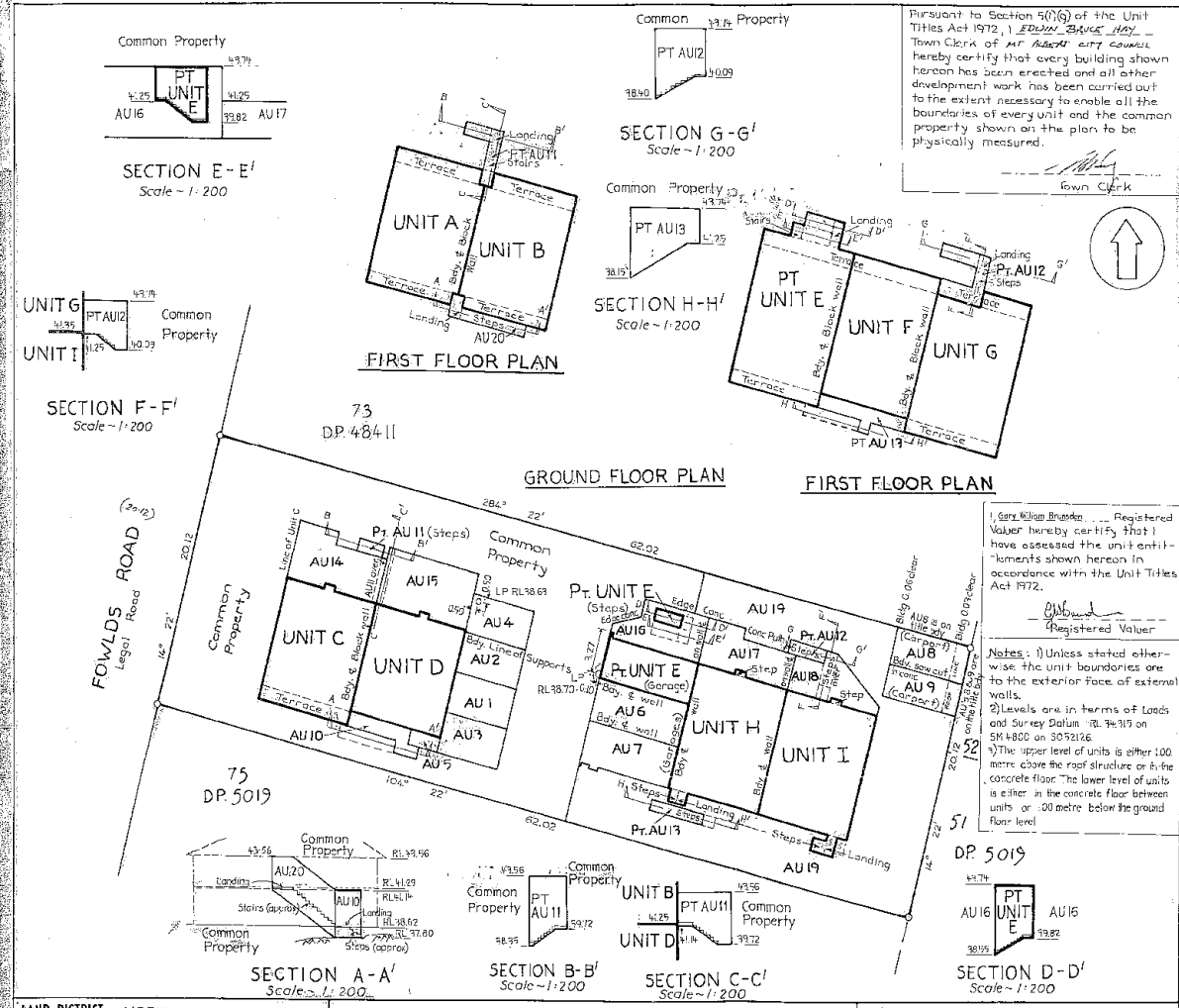

Pursuant to Section 5(1)(g) of the Unit Titles Act 1972, I EDWIN BAILEY HAY, Town Clerk of MT ALBERT CITY COUNCIL hereby certify that every building shown hereon has been erected and all other development work has been carried out to the extent necessary to enable all the boundaries of every unit and the common property shown on the plan to be physically measured.

[Signature]
Town Clerk

Approvals

[Signature]
Registered Owner

Address of Body Corporate No 22 Fowlds Road Mt Albert

SCHEDULE						
Description	Area (sq m)	Unit Entitlement	Height (m)	Units	C.T.	Allocated
Unit A	74	10.71	46.30	41.25	68C-376	
Unit B	74	10.56	46.40	44.25	68C-377	
Unit C	68	10.04	41.25	37.60	68C-378	
Unit D	61	9.78	41.25	37.60	68C-379	
Unit E	91	10.85	45.60	37.70	68C-380	
Unit F	74	10.91	46.60	41.35	68C-381	
Unit G	24	10.51	46.60	41.35	68C-382	
Unit H	91	10.58	41.35	37.70	68C-383	
Unit I	74	10.18	41.35	37.70	68C-384	
AU 1	19	40	41.14	37.60		
AU 2	14	40	41.14	37.60		
AU 3	15	40	41.14	37.60		
AU 4	14	40	41.14	37.60		
AU 5	7	7	41.14	37.60		
AU 6	22	66	41.35	37.70		
AU 7	23	66	41.35	37.70		
AU 8	19	40	42.00	37.00		
AU 9	11	40	42.00	37.00		
AU 10	7	15	41.14	37.60		
AU 11	6	19	43.54	38.35		
AU 12	10	27	43.74	38.40		
AU 13	12	25	43.74	38.15		
AU 14	27	11	41.25	37.60		
AU 15	31	13	41.25	37.60		
AU 16	21	9	41.35	37.70		
AU 17	20	8	41.35	37.70		
AU 18	18	8	41.35	37.70		
AU 19	271	127	41.35	38.00		
AU 20	12	15	43.54	37.60		

I, Gary William Bruden, Registered Valuer hereby certify that I have assessed the unit entitlement amounts shown hereon in accordance with the Unit Titles Act 1972.

[Signature]
Registered Valuer

Notes: 1) Unless stated otherwise the unit boundaries are to the exterior face of external walls.
2) Levels are in terms of Leach and Survey Datum (RL 74.317) on SM 1800 on 30/5/12.
3) The upper level of units is either 1.00 metre above the roof structure or 5. the concrete floor. The lower level of units is either in the concrete floor between units or .30 metre below the ground floor level.

LAND DISTRICT NORTH AUCKLAND
SURVEY BLK. & DIST.
NZMS 261 SHT RECORD MAP No

PLAN OF UNITS ON LOT 74 DP 5019

TERRITORIAL AUTHORITY MT ALBERT CITY
Surveyed by HILL & HAMPSON (773)
Scale 1:200 Date OCT. 1985

Deposited this 1st day of October 1987
for the Registrar
[Signature]
Deputy Chief Surveyor

File No. 6 JUL 1987
UP 119300

